



LIGHT SENSOR

Installation manual

RW231

Read the manual before you start the installation. If the instructions are not followed, this may lead to defects that cannot be claimed under warranty.



www.brel-home.com

Visit our website www.brel-home.com for more information



Scan the QR code to view the manual and instructional videos

Warnings



Do not place the motor in a damp environment



SIMPLIFIED EU DECLARATION OF CONFORMITY according to Article 10(9).

I, Erik Budding, on behalf of BREL Nederland, hereby declare that the product complies with Directive 2014/53/EU.

The full text of the EU declaration of conformity can be consulted at the following internet address:
www.brel-home.com
 Brel Nederland b.v.



The engine must be protected against water and other moist influences



The motor must be installed correctly



The antenna must be in good condition. Do not shorten this. Make sure the antenna does not come into contact with other metals. If this does happen, it will affect the function

Erik Budding
 Director Brel Netherlands



Do not allow children to play with the roller blind controls. Keep remote controls out of the reach of children. Children cannot recognize the danger of electronic devices and are therefore not allowed to work with them



Brel Netherlands B.V. is registered according to the transposition of Directive 2012/19/EU (the WEEE Directive) and to the transposition of Directive 2006/66/EC (the Battery Directive) at the Irish registry The Producer Register with the registration number 3408WB.

Installation diagram

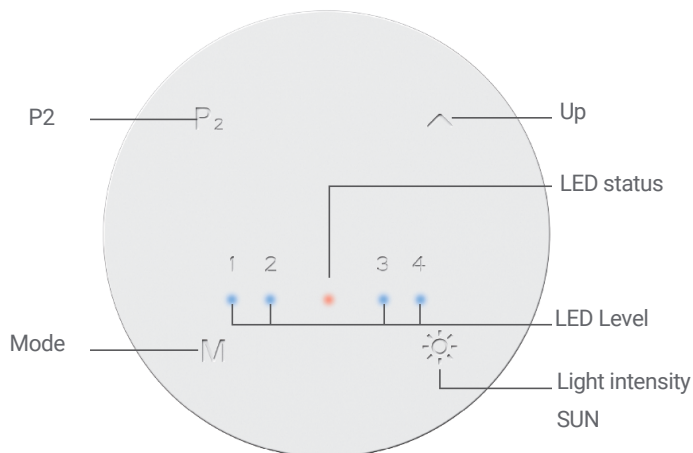

Technical specifications

Wireless reception

Battery	AAA
Temperature	-10°C~55°C
Frequency	433.925MHz

One RW231 sensor can store up to 10 transmitters or channels. If there are already 10 channels, the last channel will be overwritten in turn.

Step 1 Ambient light detection

Mode	Light intensity	Description
1	<15KLUX	The ambient light is less than 15 KLUX
2	15KLUX - 30KLUX	The ambient light is between 15 and 30 KLUX
3	30KLUX - 45KLUX	The ambient light is between 30 and 45 KLUX
4	>45KLUX	The ambient light is more than 45 KLUX

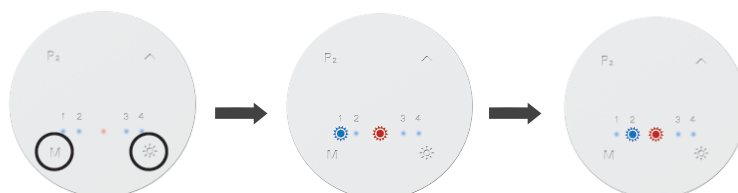

Press M + SUN at the same time.

Both the status LED and level LED are on

The value that appears is the measured light intensity

Step 2 Sun intensity

Mode	Light intensity	Description
1	X	The sensor is disabled
2	15KLUX	The sensor gives a signal from 15KLUX
3	30KLUX	The sensor gives a signal from 30KLUX
4	45KLUX	The sensor gives a signal from 45KLUX



Press SUN once



The value that appears is the current set value



Press SUN for 2 sec



The value that appears is the new set value

Step 3 Set mode

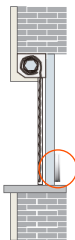

Mode 1: Roller shutter/screen

After the set value is measured for 2 minutes, the product goes down.

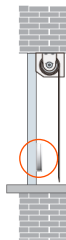
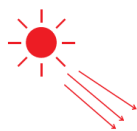

Mode 2: Inside blinds

After the set value is measured for 2 minutes, the product goes down. If the intensity is lower than the set value for 15 minutes, the product will increase again.

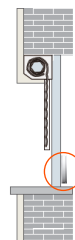

Mode 3: Roller shutter/screen

After the set value is measured for 2 minutes, the product moves down and stops above the sensor. If the intensity is lower than the set value for 15 minutes, the product will increase again.

 = placement sensor