



INSTALLATION MANUAL

Roller Shutter Motor with Wifi and obstacle stop.

BZE45

Read the manual before you begin the installation. If these instructions are not followed, this may lead to defects and injury in which warranty can't be claimed.



BREL HOME

www.brel-home.com

Visit our website for more manuals and information



BZE45-20



BZE45-40

Scan the QR code here for the manual to
download & view instructional videos



Table of Content

Warning	2
Wiring/Installing the motor/Works with BREL HOME	3
Technical data of the motor/Reach/Charging the motor	4
Functions remote control	5
Settings	5

Warning



Do not operate the motor in humid surroundings.



BREL-Motors declares that this motor has been manufactured according to the guidelines of the CE standard 1999/5/EC



The motor must be protected from direct moisture influences.



Keep the antenna in a good condition and do not shorten. The antenna should not come into contact with other metal parts otherwise it will reduce the function.



The motor must be installed correctly.



Do not allow children to play with the roller blind control unit. Keep remote controls out of reach of children. Children cannot recognize the dangers of electrical equipment and are therefore not allowed to work with it

Keep these instructions for future reference

Wiring

3 wires: 230V/50Hz

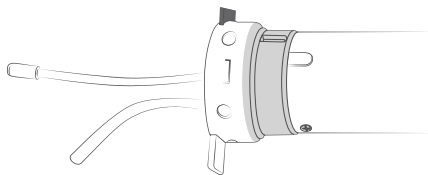
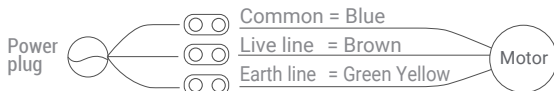

Installing the Motor

These assemblies are usually already done in the factory

Attach the crown and wheel to the motor and place the clip on the shaft of the motor so that the wheel is fixed to the motor. Install the motor with the motorbracket on the product and take care that it is secured. Place the motor in the tube of the roller/shutter.

Install with BREL HOME APP

The BZE45 motor is easy to operate with the BREL HOME app. The motor connects to the BREL HOME app via WiFi and then the motor can be set via the app. The steps are as followed:

Step 1: Go to settings -> Wifi network -> choose the connection to your home network -> disable the "automatic connection" to your home network.

Step 2: Download the BREL HOME App and create an account (SIGN UP)

Step 3: Click on add product and choose the Wifi motor

Step 4: Go through all the steps as indicated in the app.

Step 5: Close the app completely -> restart the app -> click on ADD ROOM and create the room where the product is located.

Step 6: Go to the WiFi motor and link the newly created room to the WiFi motor.

If you want to install the motor by emitter, follow the instructions on the next pages.

Scan the QR code for instruction video's

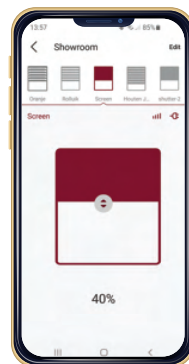

BZE45-20



BZE45-40

Technical data of the motor

	BZE45-20	BZE45-40
Motor Voltage	230V	230V
Power	161W	228W
Torque	20Nm	40Nm
Maximum motor runtime	4 min	4 min
Speed	15 rpm	15 rpm
Amperage	0.69A	0.99A
Moisture and Dust	IP44	IP44

Storage capacity is up to 20 channels

Working temperature of the motor



Heavy Use:

-10°C tot +40°C

Normal Use:

-20°C tot +70°C

Reach

① = 100 meter

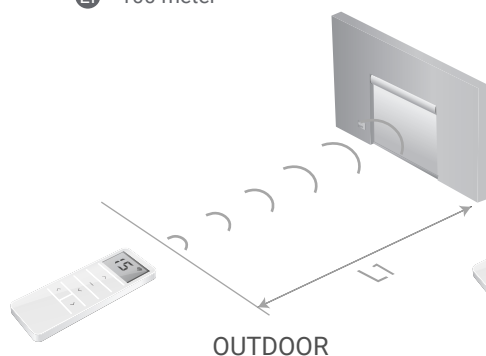

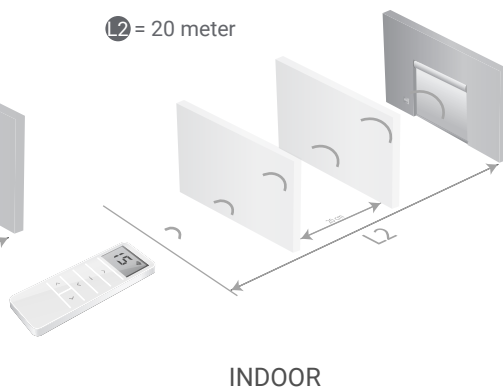

② = 20 meter

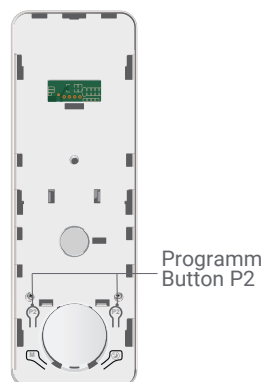
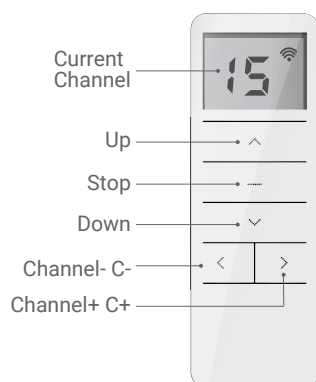

Functions Remote Control





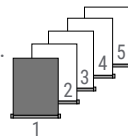

Step 1 Setting up the first remote/channel

-  The remote control can transmit 15 channels and therefore control multiple blinds. First, select a channel for operating the relevant roller blind. Make sure that you select a free channel (we recommend only 1 product per channel).
 -  This remote has also channel 0. All blinds programmed in channel 1~15 are automatically programmed in this channel 0 and can be operated all at once.
 -  In case you have selected the wrong channel, go to **Resetting factory settings**.
- ▶ **Select the desired channel.**



Step 2 Establishing connection

-  In the procedures described here is a maximum interval of 10 seconds to complete each subsequent action: if you wait any longer, the system will leave the edit mode.
-  Normally a button only needs to be pressed shortly. If you need to press and hold a button for several seconds this will be state clearly.
-  The system will confirm each completed step with moving the blind up and down (↕).
-  If a procedure does not play out as described, wait for 20 seconds and start again from the beginning of that step/procedure.



Put power on the motor and the product moves up and down.

Press and hold the STOP button until the product moves 2x up and down.

Transmitter/Channel has been set.

-  If NO end positions are set, the product will move in the pulse / step operation. Go then to STEP 3.
 - If end positions are set, the product will continue to its end position. Go then to STEP 5.
- WARNING: It is possible that the correct end positions have not been set. Go then to OPTION A.

Step 3 Adjusting the direction of rotation *(Only if the direction of rotation is not correct)*

Only possible if no end positions are set.

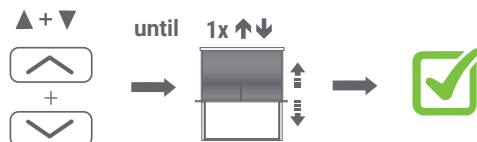

Press **UP** and **DOWN** button simultaneously, until the product moves.

The direction of rotation of the motor is **OK**.

Step 4 A Manually setting the End Limits

-  To move the motor one step: briefly press the **UP** or **DOWN** button
-  To move the motor continuously: press the **UP** or **DOWN** button for 3 seconds (ATTENTION! Press **STOP** in time)

1. Set the desired top position

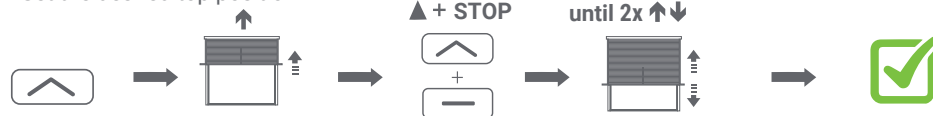

Use the operating buttons to move the product to the desired **TOP** position

Press **UP** and **STOP** simultaneously, until the product moves 2x.

The desired top position is set.

2. Set the desired bottom position



Use the operating buttons to move the product to the desired **BOTTOM** position.

Press **DOWN** and **STOP** simultaneously, until the product moves 2x.

The desired bottom position is set.

! The roller blind is now ready for use.

! If you are not satisfied with the result of setting the end positions, go to Option A - adjusting positions or **Resetting factory settings**.

Step 4 B Automatically setting the End Limits

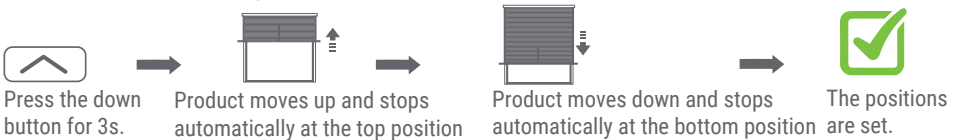

Press the down button for 3s.

Product moves up and stops automatically at the top position

Product moves down and stops automatically at the bottom position

The positions are set.

! When you activate this function, the product will automatically correct the upper limit after running up and down 50 times. Please do not stop this process

Step 5 Setting the favorite position (If desired)

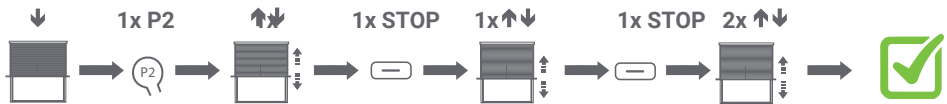

Go to the desired favorite position

Press 1x **P2** The product moves 1x up and down.

Press 1x **STOP** button. The product moves 1x up and down.

Press 1x **STOP** button. The product moves 2x up and down for confirmation.

! Press and hold **STOP** for 3 seconds to move to the favorite position.

! Remove it repeat the steps.

Additional settings

Option A Adjusting the top position

! If adjustment is not possible, go to **Resetting factory settings**.



Press at the same time **STOP** and **UP** until the motor moves.

Go to the new top position.

Press at the same time **STOP** and **UP** button, until the motor 2x moves.

Adjusting the down position

! If adjustment is not possible, go to **Resetting factory settings**.



Press at the same time **STOP** and **DOWN** until the motor moves.

Go to the new bottom position.

Press at the same time **STOP** and **DOWN** button, until the motor 2x moves.

Option B Learn Extra transmitter/channel

Only possible when end limits are set.

a = Already existing transmitter/channel

b = New transmitter/channel

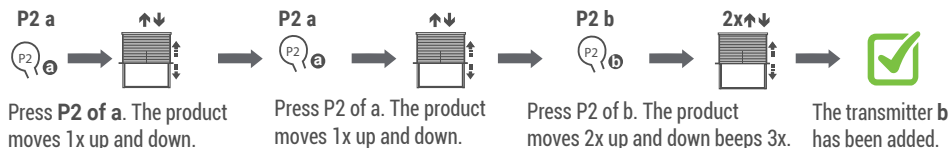
Method 1

Make sure the new transmitter is in the desired channel.

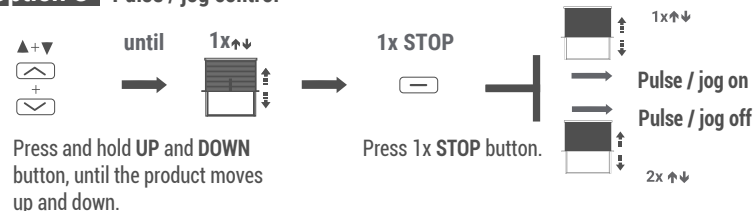
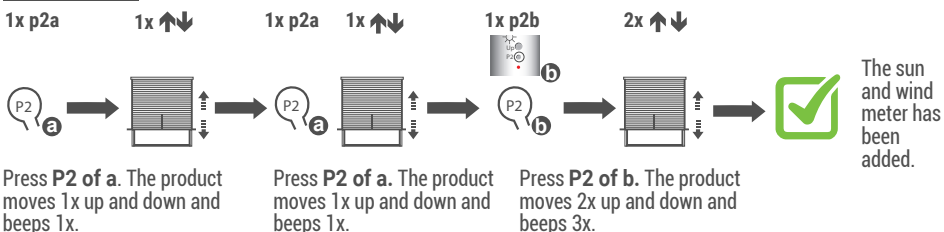
Method 2 (In case the old transmitter is lost or broken)**Option C Pulse / jog control****Option D Sun- and windmeter (DD-116 and DD-118)****Add / remove**

By repeating the above, you can remove the sun and wind meter again.

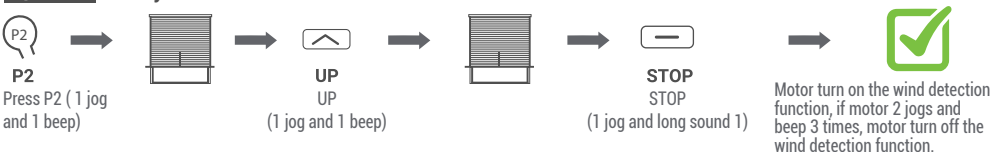
Option E Safety function for wind sensor

* The factory default mode is ON; After the wind detection function is turned off, it can work normally without receiving the response signal for 30 minutes.

NOTE When a wind sensor has been connected to the motor this function be activated. When the motor does not receive a signal every 30min of the wind sensor the awning will go up. If the wind sensor is broken the awning will go in automatically after 30 minutes.

Option F On / off sun function (Factory setting = on)

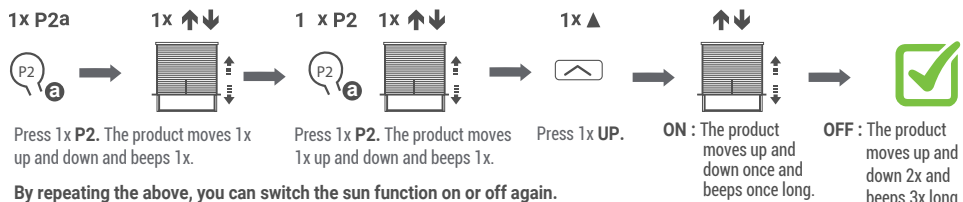

Option G Motor lower limit return function

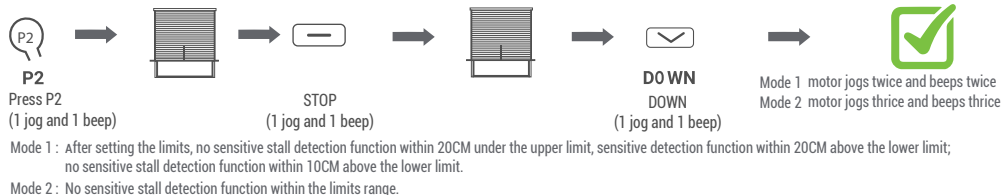

Option H Sensitive Stall Detection

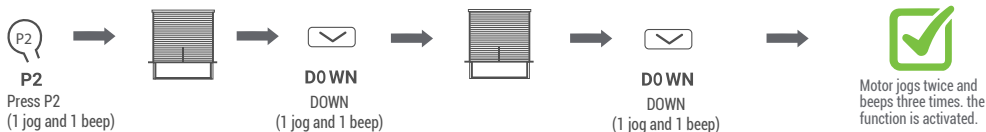

Option I Motor Mode Switch

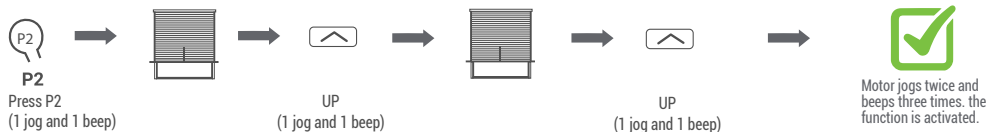

Option J Activating Wi-Fi Function

